

SENSORVIEW 2.92mm NMD connectors are precision connectors for microwave application up to 40GHz. The NMD connector is a ruggedized test-port connector used on network analyzers. This connector include a large threaded body that is specially designed to stabilize the test port cable when attached to the front of the network analyzer and allows the use of standard 3.5mm and SMA cable and adapters.

2.92mm(f) NMD to 2.92mm(f)

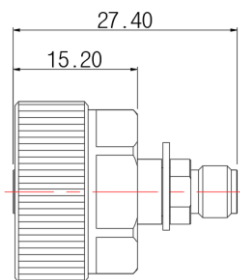

P/N : ADKK02_NMD

Characteristics

Electrical Characteristics

Impedance	50 Ω
Frequency range	DC ~ 40GHz
VSWR max.	< 1.2
Insertion Loss	> -0.26
RF Leakage	-90 dB max
Voltage rating	250 V rms, 50Hz

Environmental Characteristics

Temperature range	-55°C~125°C
-------------------	-------------

Parameter	Frequency[GHz]	Typ.	Max.
VSWR	DC - 5	1.05 : 1	1.2 : 1
	5 - 10	1.05 : 1	1.2 : 1
	10 - 20	1.05 : 1	1.2 : 1
	20 - 40	1.12 : 1	1.2 : 1
Insertion Loss [dB]	DC - 5	-0.07	-
	5 - 10	-0.08	-
	10 - 20	-0.12	-
	20 - 40	-0.20	Min -0.26

Typical Performance data

Frequency [GHz]	VSWR	Insertion Loss [dB]
0.5	1.02 : 1	- 0.03
1.0	1.03 : 1	- 0.04
5.0	1.05 : 1	- 0.07
10.0	1.02 : 1	- 0.08
15.0	1.05 : 1	- 0.09
20.0	1.03 : 1	- 0.12
25.0	1.07 : 1	- 0.15
30.0	1.02 : 1	- 0.15
35.0	1.12 : 1	- 0.17
40.0	1.10 : 1	- 0.20

ADKK02_NMD
VSWR

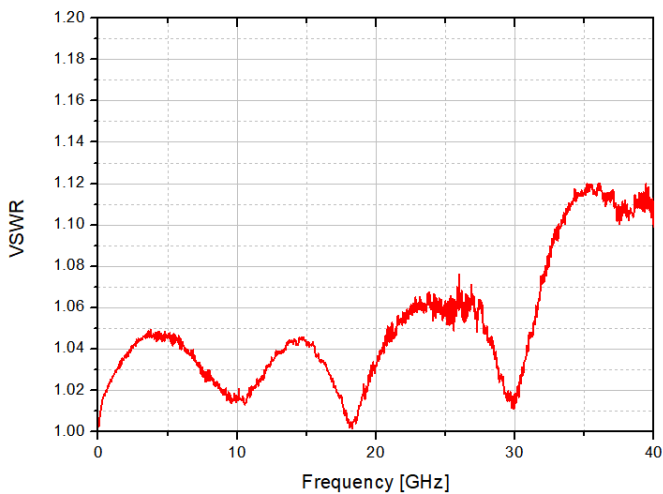

ADKK02_NMD
Insertion Loss

